

**Double Depth Panels -**  
Join to sign supports together using PCW-M14-M8 to create a double-depth sign.

**Need A Longer Support? -**  
Join two sign supports together using PCW-M14-M8 to make a desirable length support.

Compatible with  
Aluminum Sign  
Standoffs with  
M8 Stud-Caps

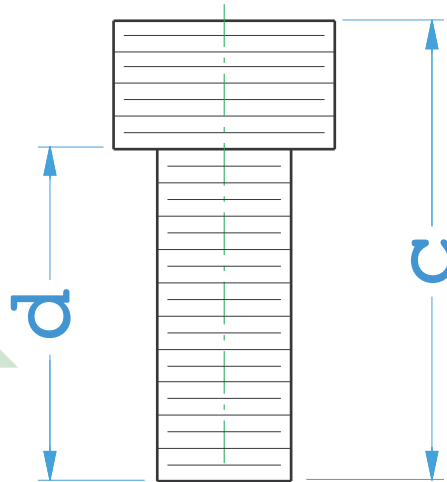
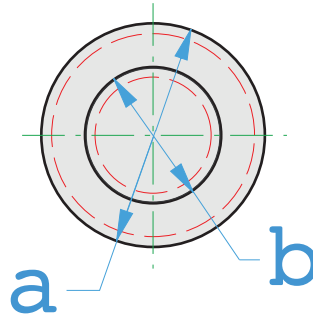

## SUPPORT JOINER / PANEL SPACER WITH M8 STUD

Part #	Thread Size (a)	Thread Size (b)	Length (c)	Stud Length (d)
<b>PCW-M14-M8</b>	M14 x 1.0	M8 x 1.0	28mm (1-1/8")	20mm (3/4")
	Panel Thickness	Load Limit	Allen Wrench	Finish
	12mm (1/2") max	11.5kg (25lb) each *Subject to fixing	N/A	Unfinished Brass